

# PHASE I

# PHASE II

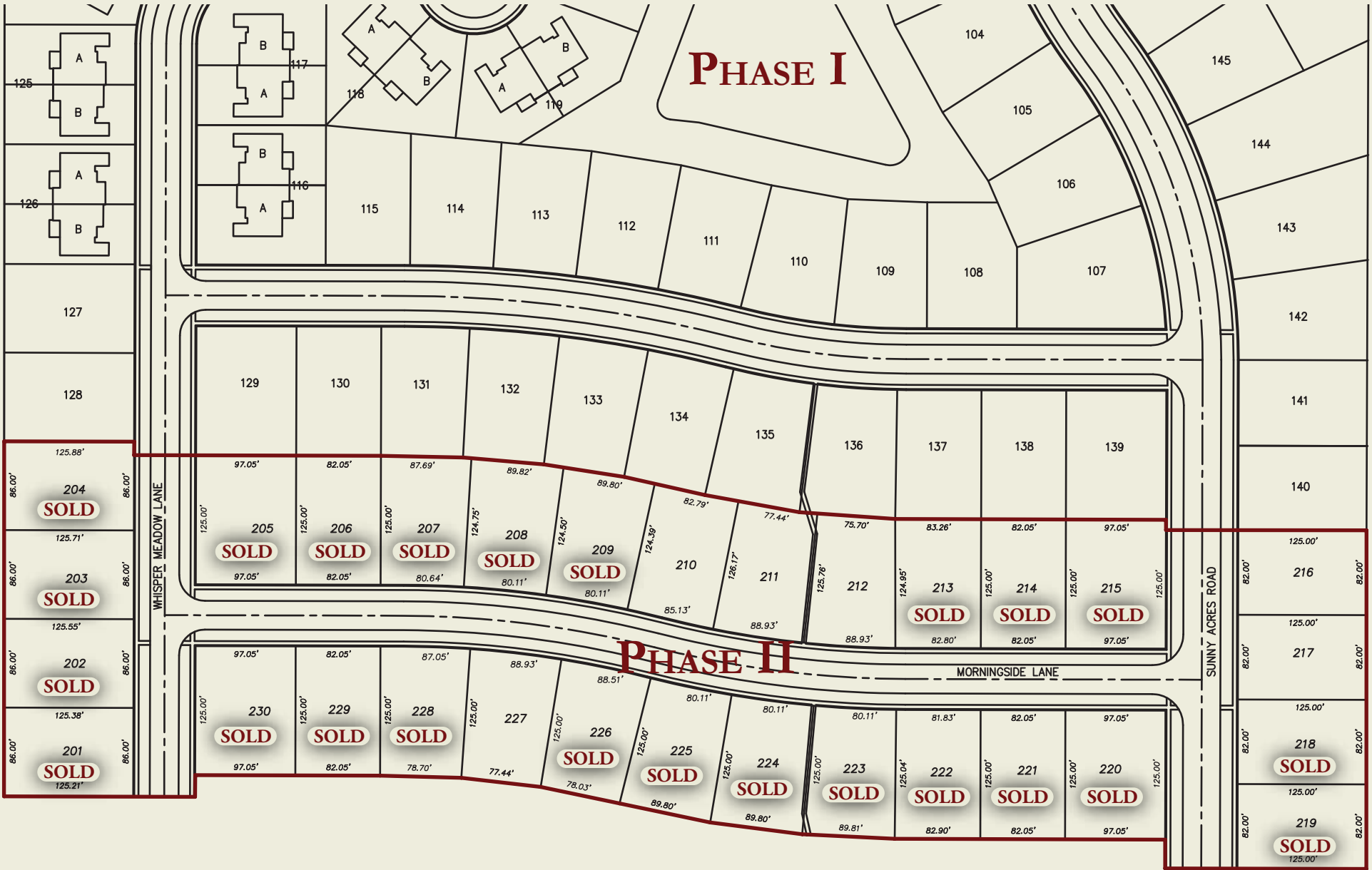

We reserve the right to modify this information at any time without notice.



# WHISPER MEADOW PHASE II

Whisper Meadow Development, LLC • 1600 Spring Creek Drive • Mahomet, Illinois 61853  
 (217) 586-4111 • <http://www.WhisperMeadow.com> • [info@WhisperMeadow.com](mailto:info@WhisperMeadow.com)